

#### Features

- UFD ( Ultra Fast Diode )
- Ultrafast and Ultrasoft recovery

ASSEMBLED IN KOREA

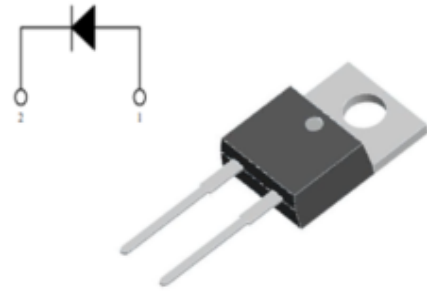

#### Maximum Ratings, $T_J=25^\circ\text{C}$

Item	Symbol	Ratings	Units
Repetitive Peak Reverser Voltage	$V_{RRM}$	1200	V
Average Forward Current	$I_F$	20	A
Non-Repetitive Peak Surge Current@8.3ms	$I_{FSM}$	200	A
Storage Temperature Range	$T_{stg}$	- 55~175	$^\circ\text{C}$
Operating Junction Temperature	$T_J$	175	$^\circ\text{C}$

#### Electrical Specifications, $T_J=25^\circ\text{C}$

Parameter	Symbol	Test Condition	Min	Typ	Max	Units
Break Voltage	$V_{BR}$	$I_R=100\mu\text{A}$	1250	-	-	V
Leakage Current	$I_R$	$V_R=1200\text{V}$	-	-	2	$\mu\text{A}$
Forward Voltage	$V_F$	$I_F=20\text{A}$	-	1.85	2.4	V

#### Dynamic Recovery Characteristics, $T_J=25^\circ\text{C}$

Parameter	Symbol	Test Condition	Min	Typ	Max	Units
Reverse Recovery Time	$T_{rr}$	$I_F=0.5\text{A}$ $I_R=1\text{A}$ $I_{rr}=0.25\text{A}$	-	50	75	ns

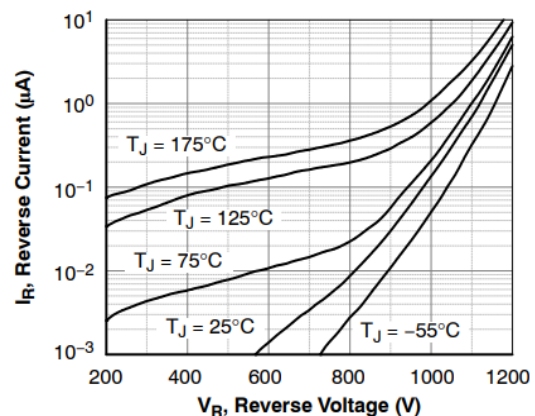
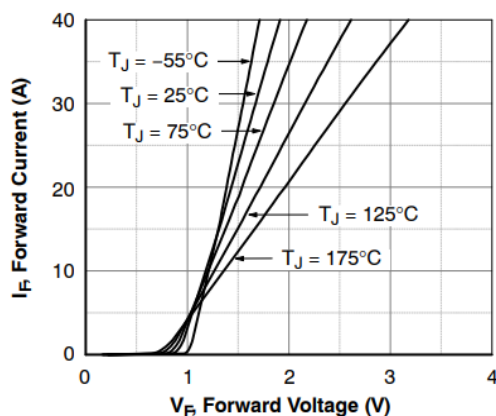

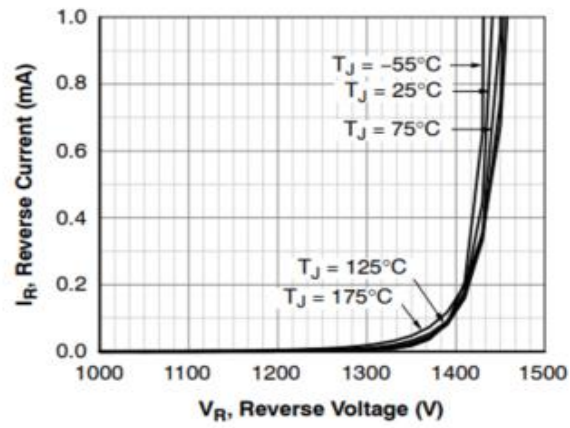

## Package Dimension

TO-220-2L

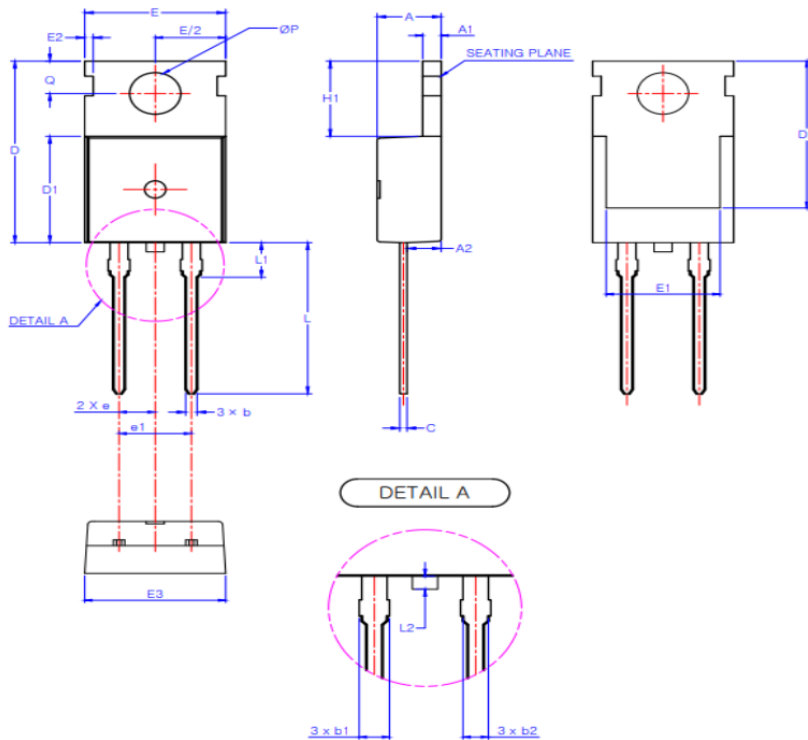

SYMBOL	MIN	NOM	MAX
A	4.30	4.50	4.70
A1	1.25	1.30	1.40
A2	2.20	2.40	2.60
b	0.70	0.80	0.90
b1	1.42	1.52	1.62
b2	1.17	1.27	1.37
c	0.45	0.50	0.60
D	15.50	15.70	15.90
D1	9.00	9.20	9.40
D2	(12.70)		
E	9.70	9.90	10.10
E1	(8.00)		
E2	(0.60)		
E3	9.70	9.90	10.10
e	2.54 BSC		
e1	5.08 BSC		
H1	6.30	6.50	6.70
L	12.88	13.08	13.28
L1	(3.00)		
ØP	3.50	3.60	3.70
Q	2.70	2.80	2.90