

# JCB35Q Controller

Application field - Medical Line  
Preferably in medical and rehabilitation

JCB35Q is mainly used in medical and rehabilitation, with excellent performance and switch power supply, which is universal in the world. JCB35Q has elegant appearance and compact design. The fixing blocks on both sides of the lower shell can be locked on the platform by screws, The fixed slide block of the lower shell can be locked to the platform by screws, and can also be fixed to various types of actuators by special inserting connectors.

When the actuator reaches the limit point in JCB35Q system, the motor power supply will be cut off by the signal switch in the actuator.



## General Features

<b>Power:</b>	Input_100-240VAC, 50/60 Hz
<b>Transformer power:</b>	50W / 100W can be optioned
<b>Power point light:</b>	Yes
<b>Actuator interface:</b>	Max. 4 channels, 4-pin actuator straight plug
<b>Handset interface:</b>	1 channels, 9-pin actuator straight plug
<b>Battery interface:</b>	1 channel, 6-pin actuator straight plug (output 30uA - actuator does not move)
<b>Standby power:</b>	Maximum 1W (230V)
<b>Colour:</b>	Black / Grey
<b>Control idea:</b>	Relay, the service life exceeds 20000 cycles
<b>Duty cycle:</b>	2/18 @ 25°C; on/off continuous use
<b>Weight:</b>	0.6kg
<b>Actuator compatibility:</b>	General actuator
<b>Battery management:</b>	The power supply of the battery can be cut off at low voltage, and there is charge and discharge management inside the battery
<b>IP grade:</b>	Max. IPX6
<b>Safety system:</b>	Switching power supply thermal protection / Over-current protection
<b>Position:</b>	Compatible with actuators equipped with special mounting brackets; bed frame (via screws)
<b>Line card:</b>	All ports have
<b>Approval:</b>	IEC 60950-1/KC60950-1 KN32 KN35 IEC/EN60601-1-2 ANSI/AAMI ES60601-1 CSA CAN/CSA-C22.2 NO. 60601-1:14

# Usage

Operating Temperature:	+5 °C to +40°C
Storage Temperature:	-10°C to 50°C
Relative Humidity:	20% - 90% under 30°C , non condensing
Atmospheric Pressure:	860 to 1060 hPa
Altitude:	Max. 2000m

# Dimension Drawing

## General

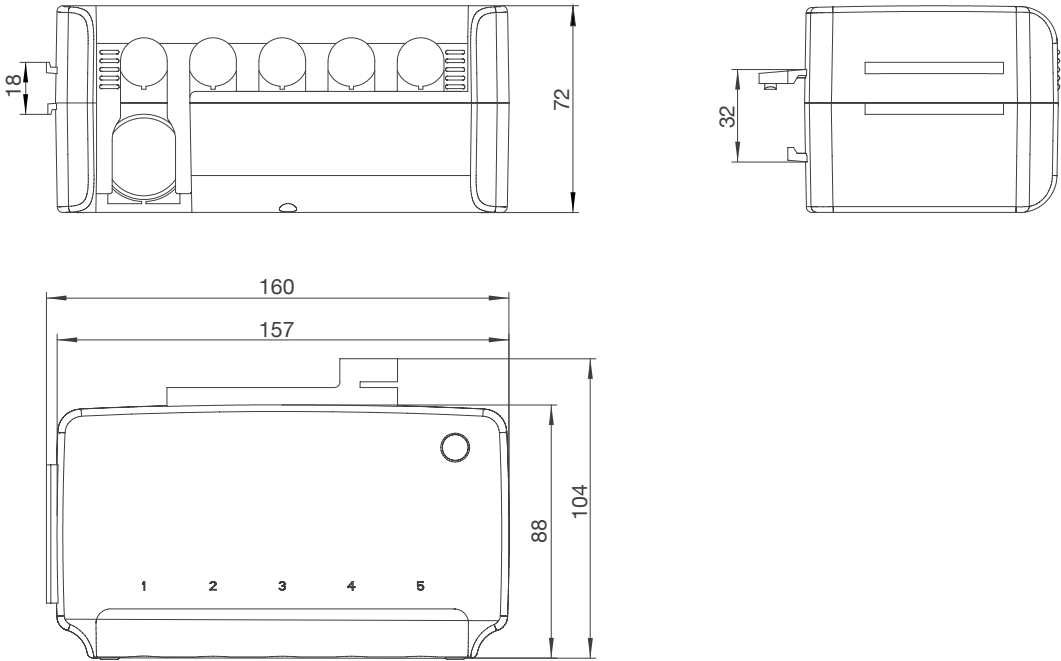

Installation type

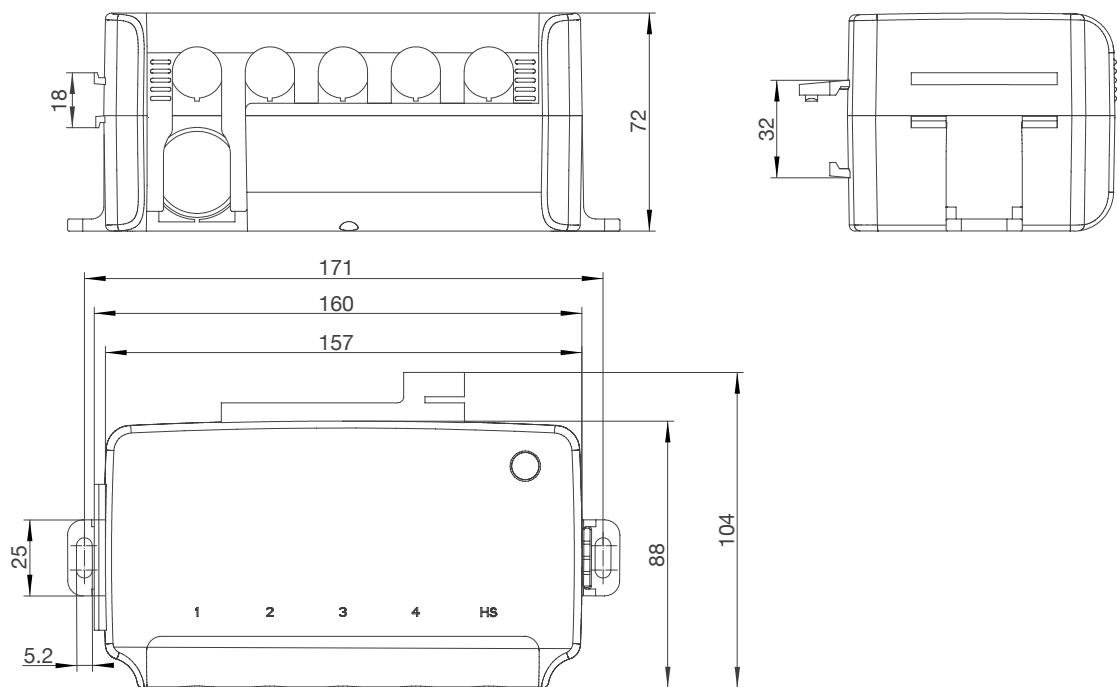

Ordering Examples

Take **JCB35Q045B0250010** for example

Model	JCB35Q	
Extension function	A	A = With batter / M = With chip / Y = Remote control
Actuator amount	4	1 = 1 actuator / 2 = 2 actuator / 3 = 3 actuator / 4 = 4 actuator
Input voltage	5	1 = 110VAC / 2 = 220VAC or 230VAC or 240VAC 3 = 110VAC-240VAC / 4 = 10-20VDC (including 20) 5 = 20-30VDC (including 30) / 6 = 30-42VDC (including 42)
Color	B	G = Gray / B = Black
PCB board	Q0026	Q0026 = Specify code
Power or capacity	50	50 = 50W / 100 = 100W
Optional function	02	02 = With study button / 03 = With ground lead 05 = With wireless / 10 = With pole for earth wire 14 = Outgoing line with emergency stop switch 17 = Class I / 18 = Class II

# Platform - system overview

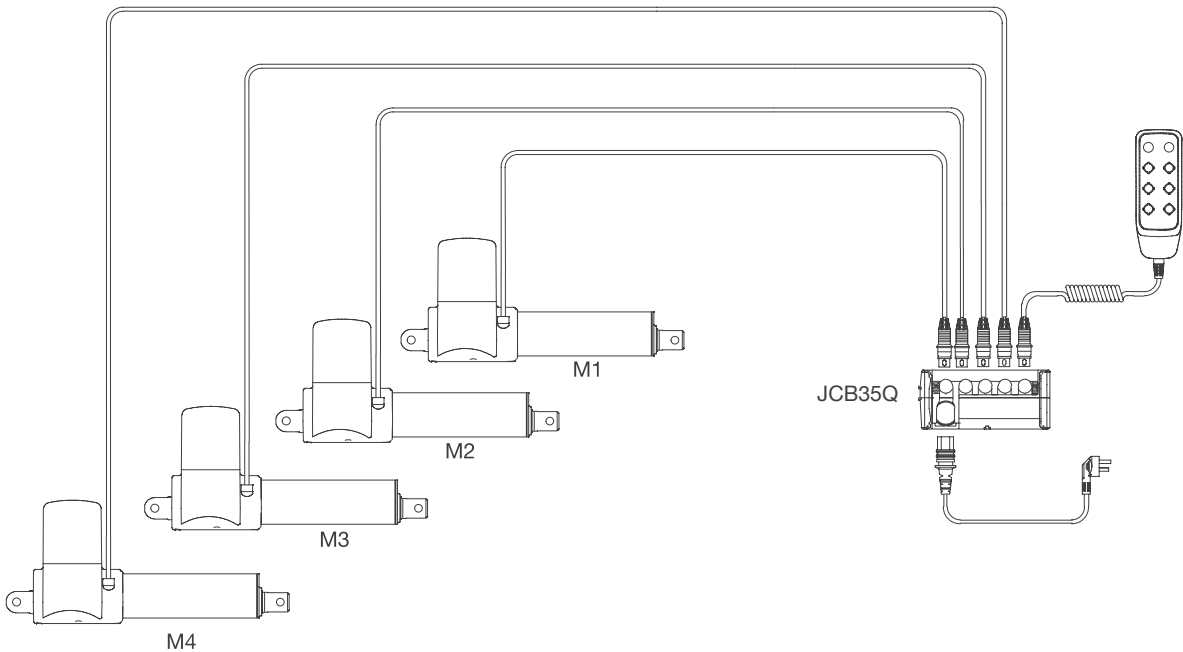

## Install

### Installation connector

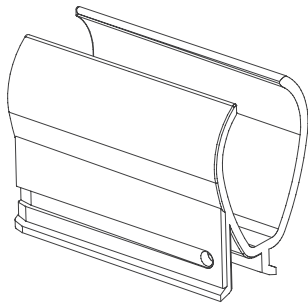
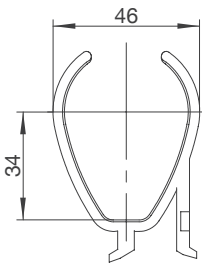
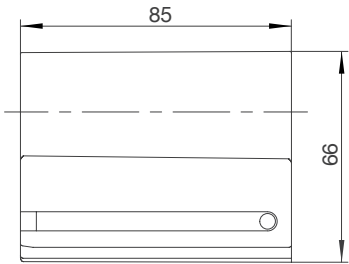

**Dimensions JCB35Q with linear actuators**

**JCB35Q (general type) is installed on JC35L3 linear actuators**

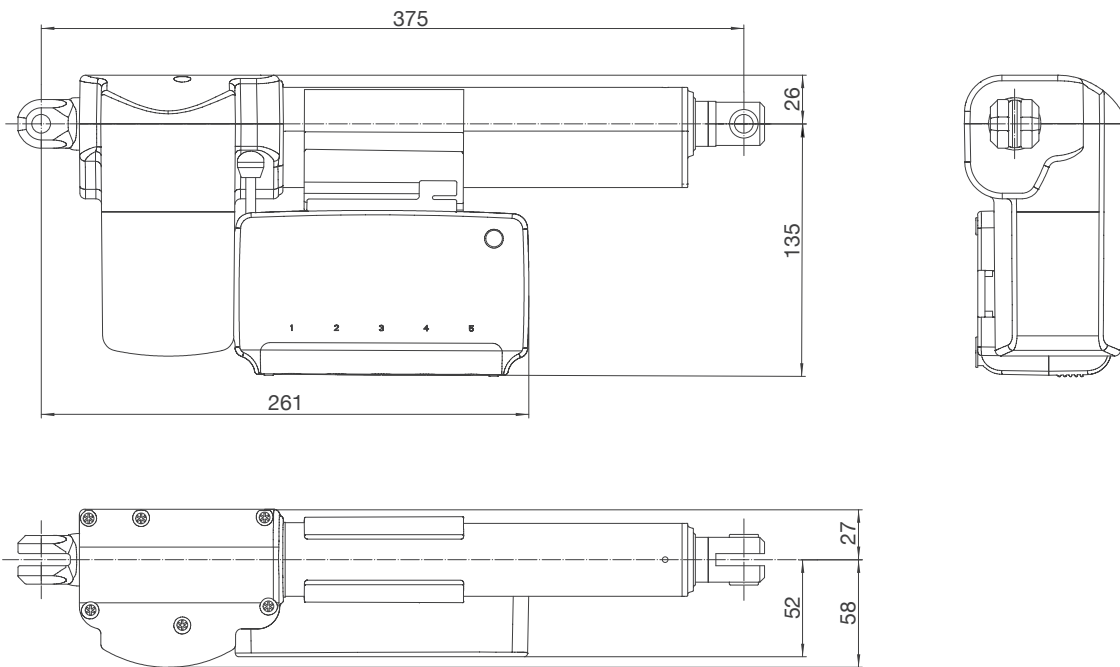

**JCB35Q (installation type) is installed on JC35L3 linear actuators**

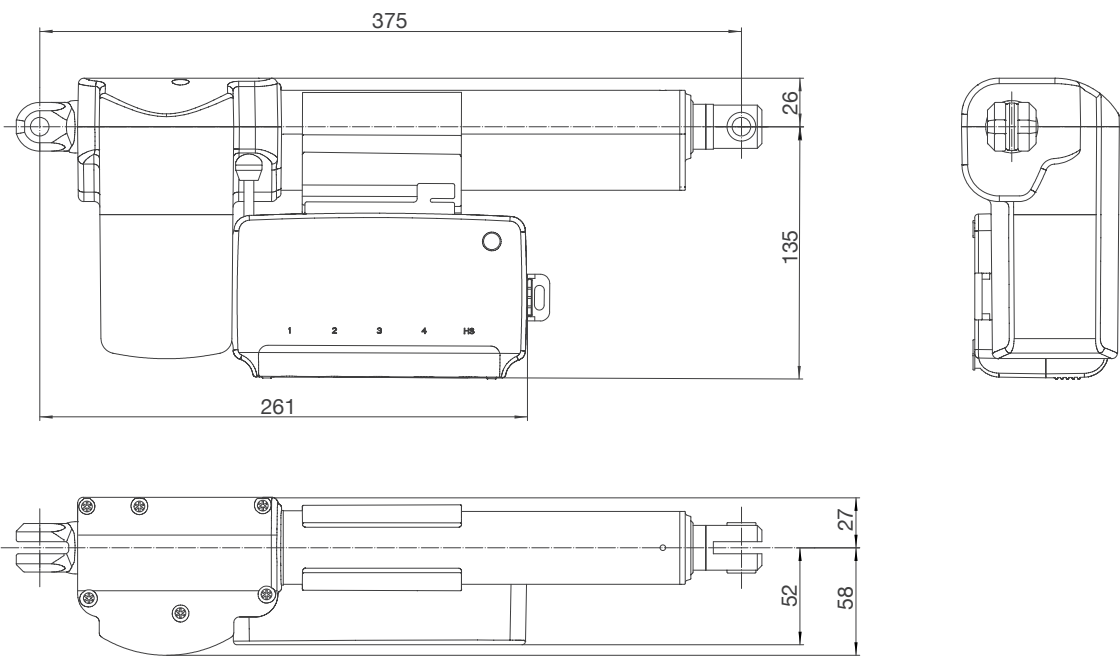

JCB35Q (general type) is installed on JC35L9 linear actuators

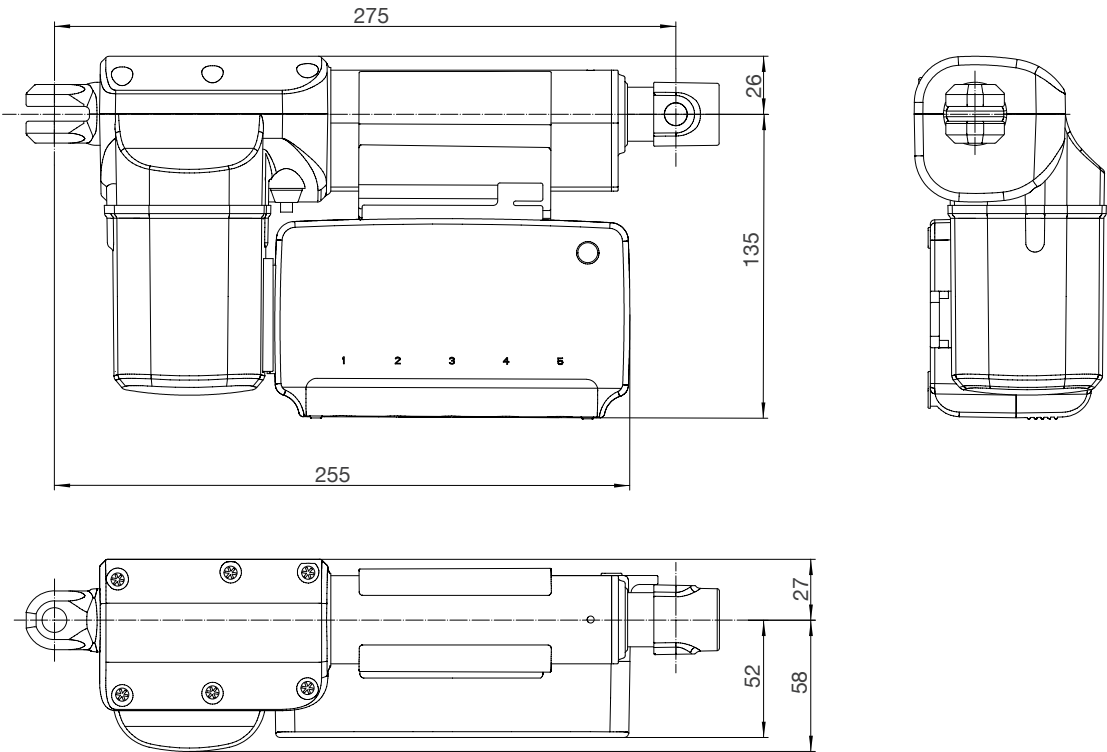

JCB35Q (installation type) is installed on JC35L9 linear actuators

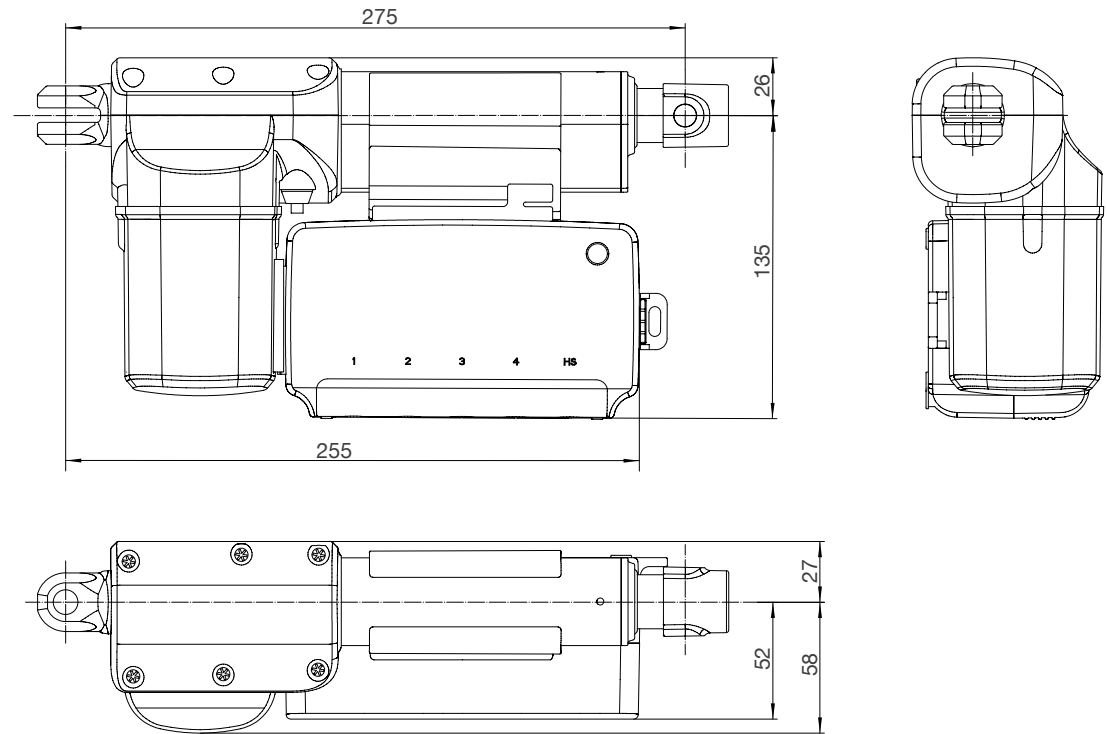

**JCB35Q (installation type) is installed on the frame**

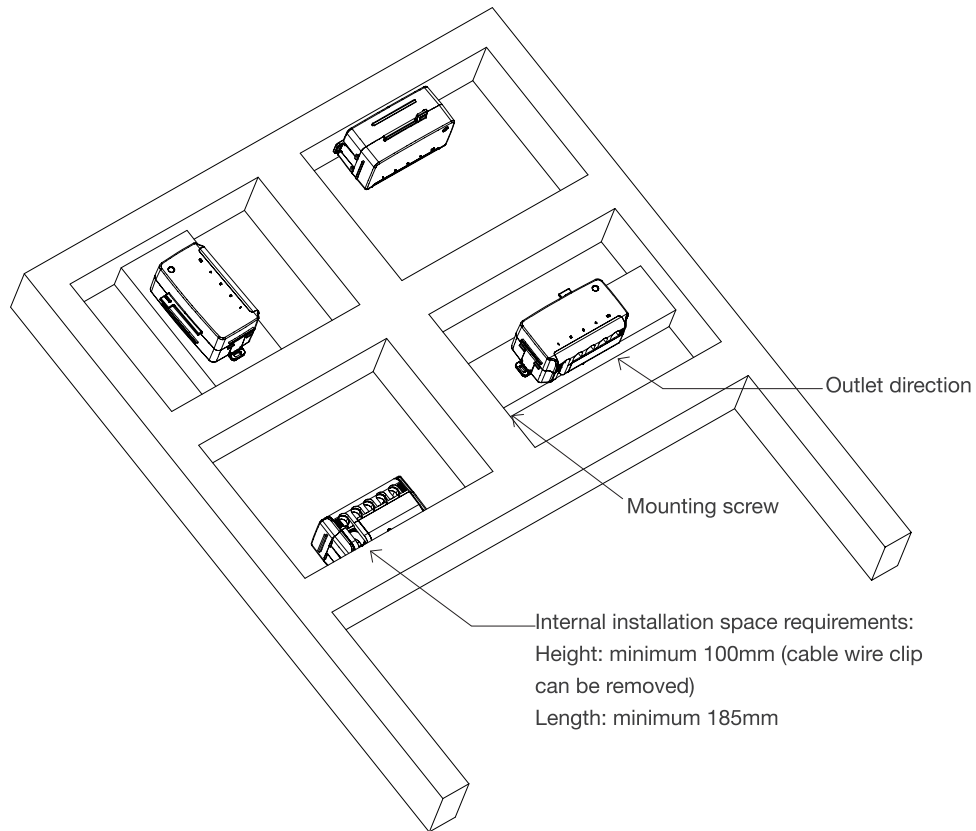

It is recommended that JCB35Q be installed in a position where it can drain water.

Recommended torque:  $0.6\text{Nm} \pm 0.1$

The controller can be installed on the bed frame or any other application according to one of the following procedures:

- (1) Place the M5 nut on the exposed hole of the installing slide and lock the mounting block with the M5 bolts from rear side.
- (2) Fix the installing slide with M5 machine screw with flat washer (install a nut on the back of the installing slide )
- (3) Fix the installing slide to the frame with self-tapping screws

## Cable locking and management

### Linear actuator cable locking

1. The control box JCB35Q has a wire clip with a unique design. Installing the wire clip is equivalent to an integrated cable lock.
2. Install the cable plug into the control box, close the cable until it snaps into the place (according to the arrow)

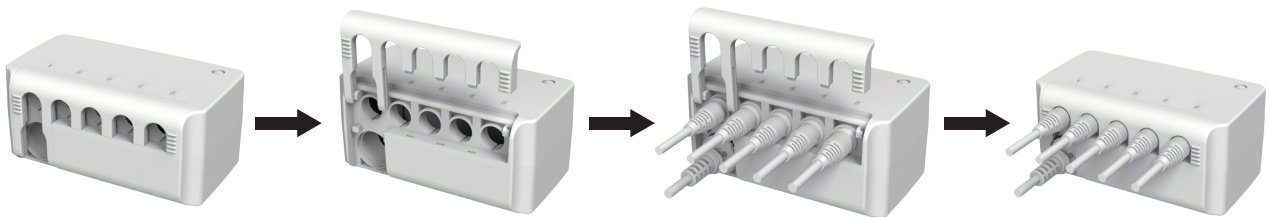

### LED indication

JCB35Q has a green LED power indicator.  
The LED lights up when JCB35R is successfully connected to the main power network (display green);  
In other cases, the LED is off.







#### **Strictly abiding by medical safety certifications**

Passed EMC tests. To ensure our products pass all kinds of tests domestic or abroad.



#### **Communication protocol development**

Aiming at different applications, develop more extensive functions for control system.



#### **Professional customization**

Powerful R&D strength, fully satisfy customers' needs. Development cycle is about 10 days, seizing more market opportunities



#### **Intelligent Control of Bluetooth**

Mobile phone as the remote, applying in home care. Market pioneer, Jiecang provides better choices



#### **Wireless Communication**

Controllers adopt high-frequency wireless system. It can avoid interference mixing with signal receivers, assisting in remote control over medical equipment.



#### **Latest Weighing System**

Designed for physiotherapy beds and medical care beds. Cantilever carrying weighing sensor, it is applicable to different bedsteads dispensing with any adjustment

#### **Disclaimer and Exclusion of Liability**

The user must determine the suitability of JIECANG products under specific conditions. JIECANG is committed to providing the latest product information. However, as JIECANG' s product are constantly improving, it is possible to make changes to JIECANG' s product without prior notice. Therefore, JIECANG cannot guarantee the correctness and authenticity of the product information. Although JIECANG will do its best to meet the order requirements, due to the above reasons, JIECANG cannot guarantee the delivery capacity of any specific product.

Therefore, JIECANG reserves the right to stop selling any products listed on the website or product catalog or other JIECANG written materials. All sales activities must be carried out in accordance with the requirements of JIECANG sales and Delivery Standard Clauses. For copies of relevant documents, please contact JIECANG.



Notes for mounting and usage can be found in the corresponding mounting manual