

MONITOUCH

V10 Replacement Guidance [V6 series]

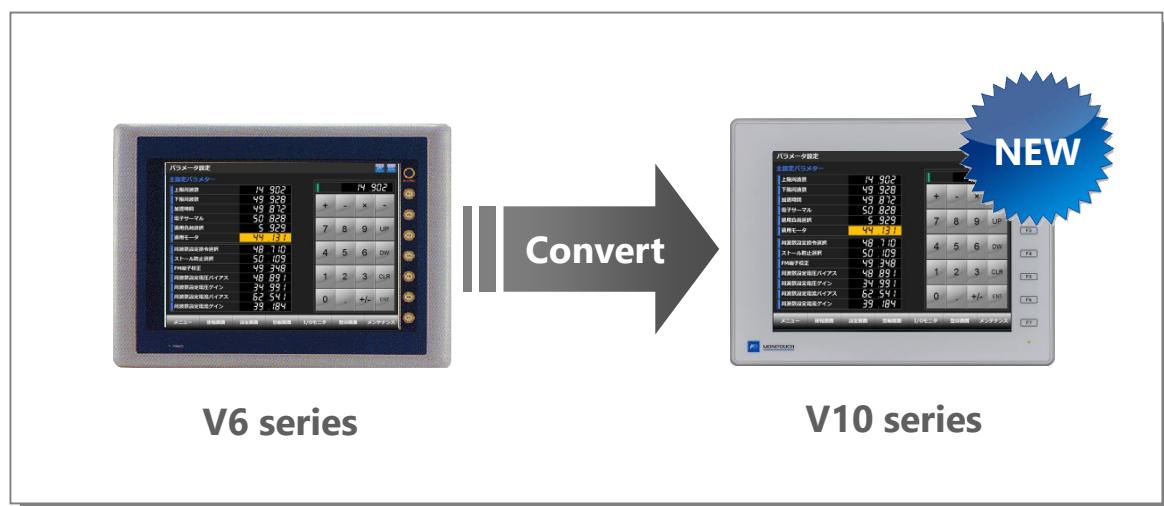

[- List of Recommended Replacement Models](#) [Page 2](#)

[- Configuration Software](#) [Page 6](#)

[- Screen Program Conversion](#) [Page 6](#)

- List of Recommended Replacement Models

Following is a list of V10 replacement models for V6 series. Please check the model of V6 unit in use and select the recommended replacement model.

Size	V6 model		V10 model		Refer to
			Light Gray	Black	
12.1-inch SVGA	V612Txx	V612TxxM *1	V1012iS	V1012iSB	Page 3
	V612Cxx	V612CxxM *1			
	V612TxxD	V612TxxMD *1	V1012iSD	V1012iSBD	
	V612CxxD	V612CxxMD *1			
10.4-inch SVGA	V610Sxx	-	V1010iS	V1010iSB	
	V610SxxD	-	V1010iSD	V1010iSBD	
10.4-inch VGA With Video display With RGB display *2	V610Tx1	V610Tx1M *1	V1010iS	V1010iSB	Page 4
	V610Tx2	-			
	V610Tx1D	V610Tx1MD *1	V1010iSD	V1010iSBD	
	V610Tx2D	-			
10.4-inch VGA Without Video display Without RGB display	V610Tx0	V610Tx0M	If replaced with V10, the resolution will change from VGA to SVGA. If the same resolution model is required, use the V9 Lite model.		Page 5
	V610Tx0D	V610Tx0MD *1			
	V610Cx0	V610Cx0M			
	V610Cx0D	V610Cx0MD *1			
7.7-inch VGA	V608C10	-	Not available *3		
7.7-inch VGA	V608CHx	-			
8.9-inch DCGA	V609Ex0M *1	-	There are no 8.9-inch models in the V10 series. Use V9080iCD that supports "GD-80E/V609E Compatibility Setting".		-
	V609Ex0MD *1	-			
5.7-inch QVGA	V606iT10	V606iT10M *1	There are no 5.7-inch models in the V10 series. Use TS2060i which has the same size and resolution.		-
	V606iC10	V606iC10M *1			
	V606iM10	V606iM10M *1			
	V606C10	V606C10M *1			
	V606M10	V606M10M *1			
	V606eC20	V606eM20			

*1 The "M" in the model number means matrix resistance film model. The touch switches have been changed to analog resistance film in V10.

*2 When using Video/RGB display, the resolution will be changed by replacing with V10. The Video/RGB display function of V10 is scheduled to be supported in spring 2025.

*3 V608CHx is the handy model. There are no handy models in the V10 series. Use V808CH/V808iCH.

* Models with few restrictions on use are described above list of recommended replacement models. It is also possible to replace V6 with V10 other than the recommended model. Select the model according to your system.

Model Description

V6	Power supply
Screen size 12: 12.1-inch 10: 10.4-inch 09: 8.9-inch 08: 7.7-inch 06: 5.7-inch	None: 100-240 VAC D: 24 VDC
Display specifications S: TFT color LCD SVGA (10.4-inch) T: TFT color LCD SVGA (12.1-inch) : TFT color LCD VGA (10.4-inch) : TFT color LCD QVGA (5.7-inch) C: STN color LCD SVGA (12.1-inch) : STN color LCD VGA (10.4/7.7-inch) : STN color LCD QVGA (5.7-inch) M: STN monochrome LCD QVGA (5.7-inch) E: EL DCGA (8.9-inch)	Touch switch None: Analog resistance film M: Matrix resistance film
	Options 0: Without options 1: Video input 2: RGB input
	Card I/F 1: Without options 2: With card I/F

V608CH Handy model
7.7-inch, STN color LCD VGA, Analog resistance film, 24 VDC

V10	Power supply
Screen size 15: 15.0-inch VGA 12: 12.1-inch SVGA 10: 10.4-inch SVGA 08: 8.4-inch SVGA	None: 100-240 VAC D: 24 VDC
Model classification S: Standard TFT color LCD Analog resistance film	Front case color None: Light gray B: Black
	Extended communication I/F None: Without options L: Additional wired LAN R: Wireless LAN

- V612/V610S → V10 Standard



V612T
V612C



V610S



V1012iS



V1010iS

Hardware Specifications

Item		V612/V610S
Dimensions W x H x D (mm)	12.1-inch	334.0 x 270.0 x 95.8
	10.4-inch	310.0 x 240.0 x 92.3
Panel cut-out W x H (mm)	12.1-inch	313.0(+0.5/-0) x 246.2(+0.5/-0)
	10.4-inch	289.0(+0.5/-0) x 216.2(+0.5/-0)
Display device		TFT color/STN color
Display colors		128 colors
Resolution		800 x 600 dots
Touch switch		Analog resistance film Matrix resistance film
Communi- cation I/F	Serial	D-Sub 25-pin x1 : RS-232C / RS-422/485 Modular 8-pin x2 : RS-232C / RS-485
	Network	Communication unit: CU-xx
Video		4 CH ^{*4}
External storage device		Dedicated memory card ^{*5}

V10 Standard
327.8 x 261.0 x 53.4
303.8 x 231.0 x 53.8
Same as on the left
TFT color
16.7 million colors ^{*1}
Same as on the left
Analog resistance film ^{*2}
D-Sub 9-pin x1 : RS-232C / RS-422/485 ^{*3} Modular 8-pin x2 : RS-232C / RS-485
Communication unit: CUR-xx
Under development Scheduled to be released in spring 2025.
SD/SDHC/SDXC card USB flash drive

^{*1} Only for displaying "picture" images, 3D parts, video / RGB input images and remote desktop window. All other content is displayed using 65,536 colors.
^{*2} It is not possible to press two points on the screen at the same time on V10. For two-point press, change the setting to use both a switch on the screen and a function switch.
^{*3} When using the existing cable, use Hakko Electronics' conversion cable "D9-D25". When Hakko Electronics' optional unit "TC485" was used, use "TC-D9".
^{*4} Only for V612xx1, V610xx1
^{*5} When using V612x2, V610x2 or Hakko Electronics' optional unit "CREC".

- V610Tx1/V610Tx2 → V10 Standard

The optional Video/RGB unit of V10 is scheduled to be released in spring 2025.

When using V610Tx1 to display video or using V610Tx2 to display RGB input, replace with V1010iS.

The screen resolution differs between V610T and V1010iS.
V610T: 640 x 480 → V1010iS: 800 x 600 dots

When converting the screen program from V6 to V10, use automatic resizing feature of V-SFT. If the layout is changed, adjust it manually.



V610Tx1
V610Tx2



V1010iS

+ Optional unit
Under development

Hardware Specifications

Item		V610Tx1	V610Tx2
Dimensions W x H x D (mm)		310.0 x 240.0 x 92.3	
Panel cut-out W x H (mm)		289.0(+0.5/-0) x 216.2(+0.5/-0)	
Display device		TFT color	
Display colors		128 colors	
Resolution		640 x 480 dots	
Touch switch		Analog resistance film Matrix resistance film	
Communi- cation I/F	Serial	D-Sub 25-pin x1 : RS-232C / RS-422/485 Modular 8-pin x2 : RS-232C / RS-485	
	Network	Communication unit: CU-xx	
Video		4CH	-
RGB		-	1CH
External storage device		Dedicated memory card *5	

V10 Standard	
303.8 x 231.0 x 53.8	
Same as on the left	
Same as on the left	
16.7 million colors *1	
800 x 600 dots *2	
Analog resistance film *3	
D-Sub 9-pin x1 : RS-232C / RS-422/485 *4 Modular 8-pin x2 : RS-232C / RS-485	
Communication unit: CUR-xx	
Under development Scheduled to be released in spring 2025.	
Under development Scheduled to be released in spring 2025.	
SD/SDHC/SDXC card USB flash drive	

*1 Only for displaying "picture" images, 3D parts, video / RGB input images and remote desktop window. All other content is displayed using 65,536 colors.

*2 The resolution is SVGA. When converting the screen program, use automatic resizing feature of V-SFT. If the layout is changed, adjust it manually.

*3 It is not possible to press two points on the screen at the same time on V10. For two-point press, change the setting to use both a switch on the screen and a function switch.

*4 When using the existing cable, use Hakko Electronics' conversion cable "D9-D25". When Hakko Electronics' optional unit "TC485" was used, use "TC-D9".

*5 When using V610T21, V610T22 or Hakko Electronics' optional unit "CREC".

- V610Tx0/V610C/V608C → V10 Standard

The screen resolution differs between V610Tx0/V610C/V608C and V10 Standard.
V6: 640 x 480 → V10: 800 x 600 dots

If the same resolution model is required, use the V9 Lite model.
When converting the screen program from V6 to V10, use automatic resizing feature of V-SFT. If the layout is changed, adjust it manually.

Recommended Replacement Models

Size	V6 model		V10 model	
			Light gray	Black
10.4-inch VGA	V610Tx0	V610Tx0M *1	V1010iS	V1010iSB
	V610Cx0	V610Cx0M *1		
	V610Tx0D	V610Tx0MD *1	V1010iSD	V1010iSBD
	V610Cx0D	V610Cx0MD *1		
7.7-inch VGA	V608C10	-	V1008iSD	V1008iSBD

*1 The "M" in the model number means matrix resistance film model. The touch switches have been changed to analog resistance film in V10.



V610Tx0
V610C



V608C



V1010iS



V1008iS

Hardware Specifications

Item		V6	V10 Standard
Dimensions W x H x D (mm)	10.4-inch	310.0 x 240.0 x 92.3	303.8 x 231.0 x 53.8
	7.7-inch	230.0 x 175.0 x 66.1	235.0 x 180.0 x 48.7
Panel cut-out W x H (mm)	10.4-inch	289.0(+0.5/-0) x 216.2(+0.5/-0)	Same as on the left
	7.7-inch	220.5(+0.5/-0) x 165.5(+0.5/-0)	
Display device		TFT color/STN color	TFT color
Display colors		128 colors	16.7 million colors *1
Resolution		640 x 480 dots	800 x 600 dots *2
Touch switch		Analog resistance film Matrix resistance film	Analog resistance film *3
Communi- cation I/F	Serial	D-Sub 25-pin x1 : RS-232C / RS-422/485 Modular 8-in x2 : RS-232C / RS-485	D-Sub9-pin x1 : RS-232C / RS-422/485 *4 Modular 8-pin x2 : RS-232C / RS-485
	Network	Communication unit: CU-xx	Communication unit: CUR-xx
External storage device		Dedicated memory card *5	SD/SDHC/SDXC card USB flash drive

*1 Only for displaying "picture" images, 3D parts, video / RGB input images and remote desktop window. All other content is displayed using 65,536 colors.
*2 The resolution is SVGA. When converting the screen program, use automatic resizing feature of V-SFT. If the layout is changed, adjust it manually.
*3 It is not possible to press two points on the screen at the same time on V10. For two-point press, change the setting to use both a switch on the screen and a function switch.
*4 When using the existing cable, use Hakko Electronics' conversion cable "D9-D25". When Hakko Electronics' optional unit "TC485" was used, use "TC-D9".
*5 When using V610x2 or Hakko Electronics' optional unit "CREC".

- Configuration Software

Model	Software	OS	Transferring cable *1
V6	V-SFT-5	Windows Vista (32bit, 64bit) Windows 7 (32bit, 64bit) Windows 8 (32bit, 64bit) Windows 8.1 (32bit, 64bit) Windows 10 (32bit, 64bit) Windows 11(64bit)	- LAN cable *2 - V-CP (MJ to Dsub9) manufactured by Hakko Electronics Co., Ltd.
V10	V-SFT-6 Supported with version 6.2.0.0 or later		- USB cable (USB mini-B to USB-A) - LAN cable *3 - V-CP (MJ to Dsub9) manufactured by Hakko Electronics Co., Ltd.

*1 The screen program can be transferred via SD card/USB flash drive when using V10 and dedicated memory card when using V6.
*2 Available when CU-03 is installed on the V6 unit.
*3 LAN connector of V10 supports Auto-MDIX. Straight/crossover cables can be used with or without HUB.

- Screen Program Conversion

The screen program can be converted from V6 to V10 using V-SFT-6 (configuration software for V series).

- Conversion procedures

- 1. Start V-SFT and click [Open] in the Startup menu or [Open] in the [File] menu. The screen program file can also be opened by dragging it onto V-SFT-6. If using this method, proceed to step 4.
- 2. Change the file extension to [*.V6] in the [Open] dialog.

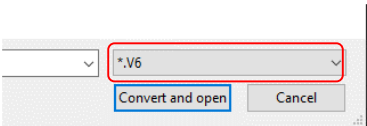

- 3. Select the V6 series screen program file and click [Convert and open]. The [Edit Model Selection] dialog appears.
- 4. Select the V10 series model and click [OK].

